

GRANTED**(IN474488)**

Apparatus for cleaning and drying of clothes

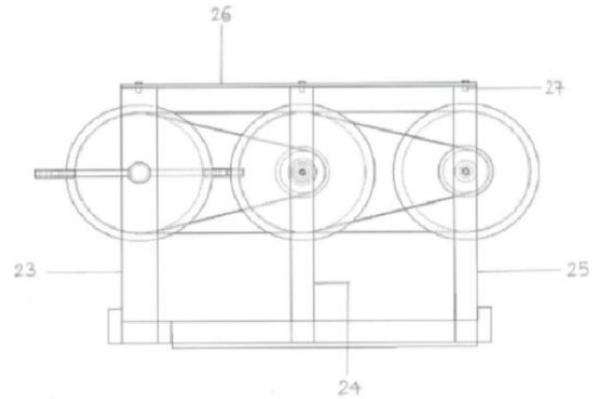

NEED

Washing and drying clothes typically requires separate processes and machines, leading to energy waste and inefficiency. This technology integrates both functions in a single unit, optimizing space and energy use.

TECHNOLOGY OVERVIEW

This apparatus uses a pedal-powered system to drive two independent pulleys, rotating a spherical drum to wash and dry clothes. The pulleys operate at different speeds without changing the pedaling speed, ensuring efficient and simultaneous washing and drying.

TECHNOLOGY KEY FEATURES

Pedal-powered operation; dual-pulley system; independent pulley speed; energy-efficient washing and drying; spherical steel net drum; space-saving design.

[Read more here](#)

MARKET ANALYSIS

The global washing machine market is projected to grow at a CAGR of 3.6% from 2023 to 2033, driven by growing demand for energy-efficient and compact appliances. (Source: Grand View Research, 2023)

Target Industries

1) Appliance manufacturers; 2) Energy-efficient solution providers; 3) Home appliance retail and e-commerce platforms.

AT A GLANCE

- SDG 7 (Affordable and Clean Energy), SDG 9 (Industry, Innovation, and Infrastructure)

Technology is available for licensing/ co-development.

Reach out to Prof. Deepak Chitkara, Coordinator, BITS Technology Enabling Centre,
BITS Pilani Contact Details: tec.bits@pilani.bits-pilani.ac.in, 91 1596-255913